

PLOTTED ON: 10/31/2016

DESIGN FILENAME: P:\11\38\01\Design\Civil\Roadway\113801_SanAntonioSt_10.dgn

MATCH LINE STA

MATCH LINE STA

MATCH LINE STA

MATCH LINE STA

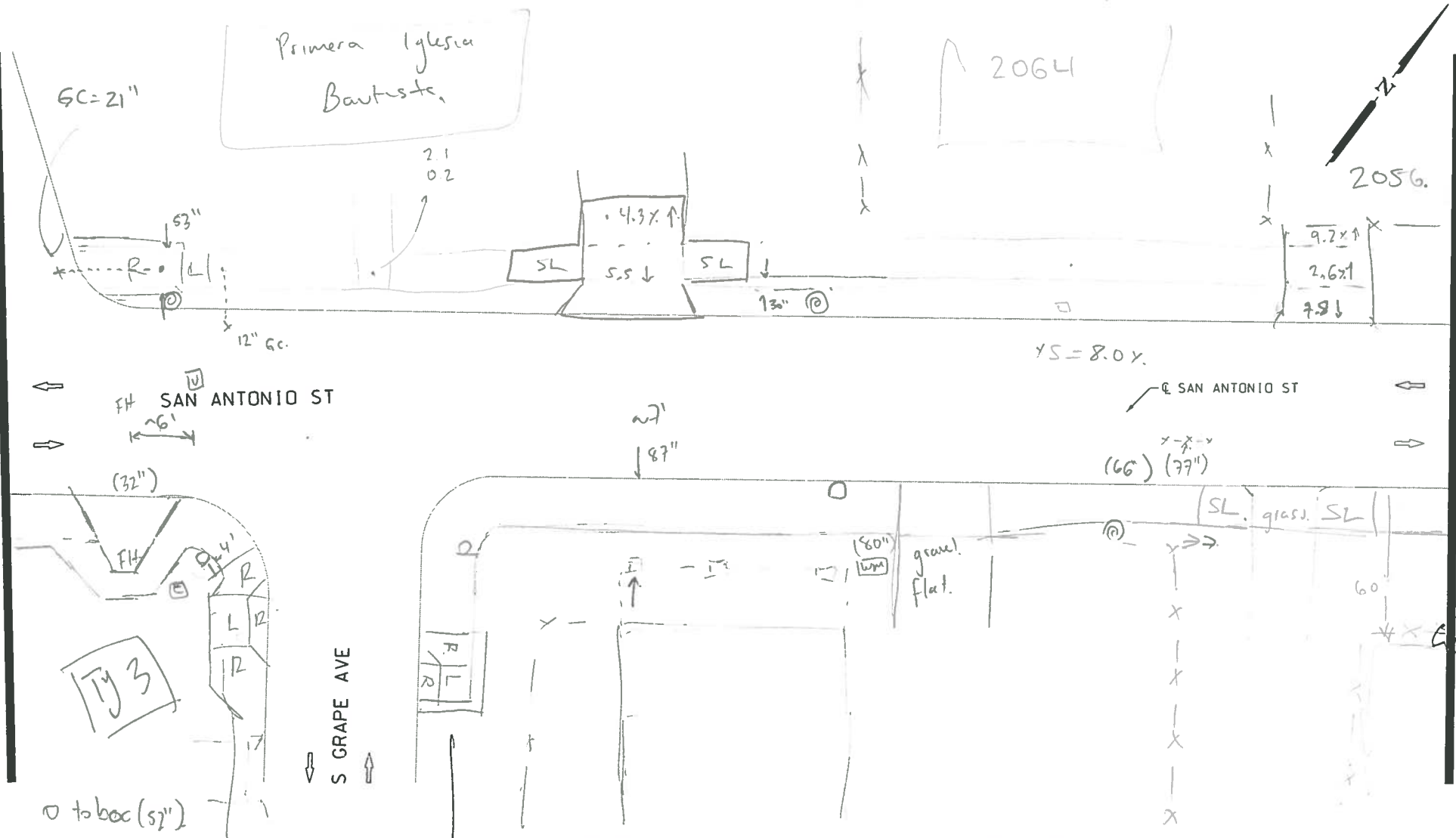

ITEM	DESCRIPTION	UNIT	QTY
------	-------------	------	-----

Aw
11/7
FD



NB_15-054_SA_10

DESIGN
INTERIM REVIEW
DOCUMENT INCOMPLETE. NOT INTENDED FOR PERMIT, BIDDING OR CONSTRUCTION.
ENGINEER: JOHN A. TYLER
P.E. SERIAL NO: 105193
DATE: 10/31/2016

REVIEW AND APPROVAL
INTERIM REVIEW
DOCUMENT INCOMPLETE. NOT INTENDED FOR PERMIT, BIDDING OR CONSTRUCTION.
ENGINEER: JAMES A. LUTZ
P.E. SERIAL NO: 84722
DATE: 10/31/2016

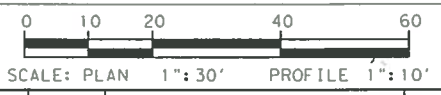

REV. NO.	DATE	DESCRIPTION	BY
----------	------	-------------	----

PAPE-DAWSON ENGINEERS

SAN ANTONIO | AUSTIN | HOUSTON | FORT WORTH | DALLAS
2000 HW LOOP 410 | SAN ANTONIO, TX 78213 | 210.375.9000
TYPE FIRM REGISTRATION #270 | TRPLS FIRM REGISTRATION #10029800



HIGHWAY
SAN ANTONIO ST

STA XXX+XX TO STA XXX+XX

SHEET 10 OF 15

DCN:	FED. RD. DIV. NO.	STATE	PROJECT NO.	HIGHWAY NO.		
CHK DGN:	6	TEXAS		VA		
DWG:	DIST.	COUNTY	CDMT. NO.	SECT. NO.	JOB NO.	SHEET NO.
CHK DWG:	SAT	COMAL				46