

Plotted on: 11/17/2022

Design File name: P:\127\75\00\Design\Civil\Drainage\1277500\_DAM01.dgn

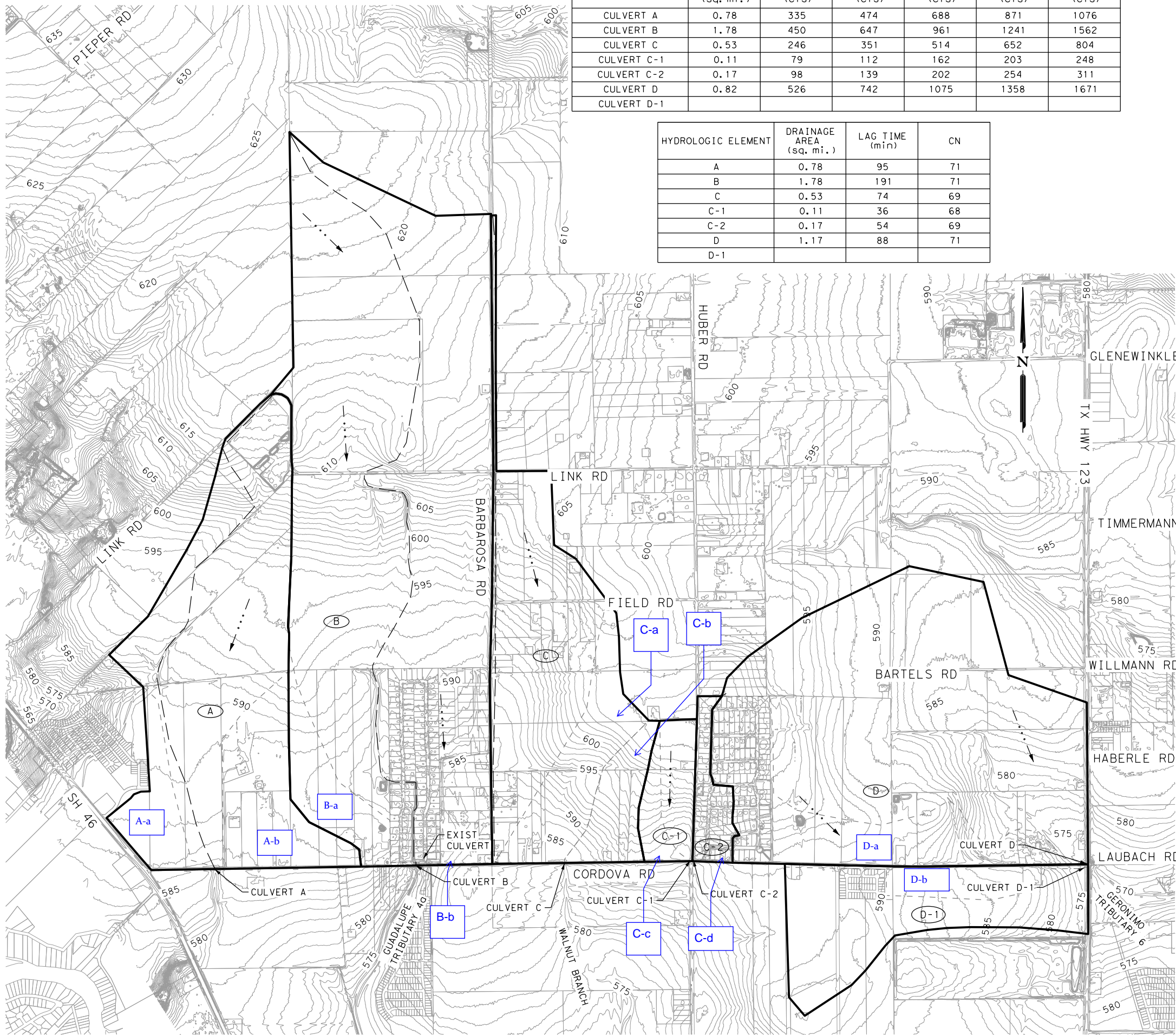

COMPUTATION POINT	DRAINAGE AREA (sq. mi.)	5-YEAR DISCHARGE (cfs)	10-YEAR DISCHARGE (cfs)	25-YEAR DISCHARGE (cfs)	50-YEAR DISCHARGE (cfs)	100-YEAR DISCHARGE (cfs)
CULVERT A	0.78	335	474	688	871	1076
CULVERT B	1.78	450	647	961	1241	1562
CULVERT C	0.53	246	351	514	652	804
CULVERT C-1	0.11	79	112	162	203	248
CULVERT C-2	0.17	98	139	202	254	311
CULVERT D	0.82	526	742	1075	1358	1671
CULVERT D-1						

HYDROLOGIC ELEMENT	DRAINAGE AREA (sq. mi.)	LAG TIME (min)	CN
A	0.78	95	71
B	1.78	191	71
C	0.53	74	69
C-1	0.11	36	68
C-2	0.17	54	69
D	1.17	88	71
D-1			

RAINFALL DEPTH (NOAA ATLAS 14, VOLUME 11)	
PROFILE	*DEPTH (in)
5 YR	5.33
10 YR	6.64
25 YR	8.67
50 YR	10.5
100 YR	12.6
* 24-HR EVENT	

RAINFALL DEPTHS OBTAINED AT MID-POINT OF CORDOVA RD USING NATIONAL WEATHER SERVICE PRECIPITATION FREQUENCY DATA SERVER (PFDS)

**LEGEND**

- R.O.W.
- DRAINAGE AREA BOUNDARY
- 850— EXISTING CONTOUR
- >— FLOW ARROW
- (X-X) DRAINAGE AREA

- NOTES:
1. DRAINAGE AREAS OFF ROW DELINEATED USING EXISTING 1-FT CONTOURS FROM 2017 GIS DATA AND FIELD VERIFIED SITE IMPROVEMENTS.
  2. HEC-HMS VERSION 4.10 AND FREQUENCY STORM HYDROGRAPH METHOD USED TO CALCULATE FLOWS.
  3. A CLIMATIC ADJUSTMENT OF -15 APPLIED TO CN.

DESIGN

INTERIM REVIEW

DOCUMENT INCOMPLETE. NOT INTENDED FOR PERMIT, BIDDING OR CONSTRUCTION.  
 ENGINEER: STEVEN J. TATE  
 P. E. SERIAL NO: 131443  
 DATE: 11/17/2022

APPROVAL

INTERIM REVIEW

DOCUMENT INCOMPLETE. NOT INTENDED FOR PERMIT, BIDDING OR CONSTRUCTION.  
 ENGINEER: JOHN A. TYLER  
 P. E. SERIAL NO: 105193  
 DATE: 11/17/2022

SCALE: 1" = 2000'

REV. NO.	DATE	DESCRIPTION	BY
<p>           SAN ANTONIO   AUSTIN   HOUSTON   FORT WORTH   DALLAS            2000 NW LOOP 410   SAN ANTONIO, TX 78213   210.375.9000            TEXAS ENGINEERING FIRM #470   TEXAS SURVEYING FIRM #10028800         </p>			
<p>It's real.</p>			
<p>©2022</p>			
<p>CORDOVA RD EXISTING DRAINAGE AREA MAP</p>			
SHEET 1 OF 1			
DGN:	FED. RD. DIV. NO.:	STATE:	FEDERAL AID PROJECT NO.:
CHK DGN:	6	TEXAS	
DWG:	DIST.:	COUNTY:	CONT. NO. SECT. NO. JOB NO.
CHK DWG:	SAT	GUADALUPE	